

# GLOB VALVE - 800#

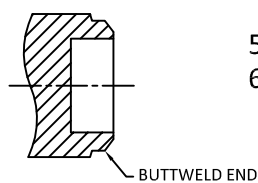
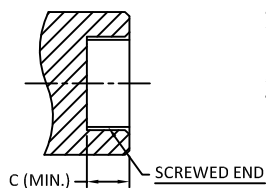
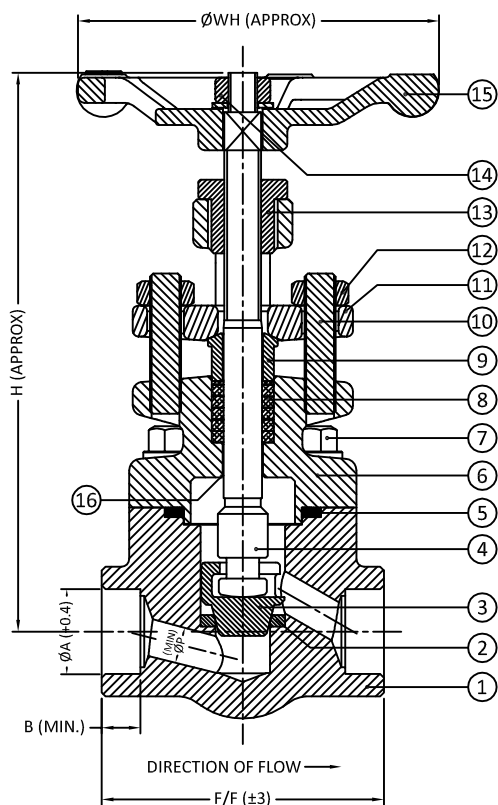

## Application Standards

- 1 - Design and manufacture conform to API 602 / ISO 15761
- 2 - Connection ends conform to
  - 1) Socket weld standard :- ASME B16.11.
  - 2) Screwed end standard :- ASME B1.20.1.
  - 3) Butt-weld standard :- ASME B16.25.
- 3 - Testing standard API 598
- 4 - Structure features
  - Bolted bonnet, outside screw and yoke
  - Welded bonnet, outside screw and yoke
- 5 - Materials conform to ANSI / ASTM
- 6 - Main materials A105, F304, F304L, F316, F316L, F5, F9, F11, F22, F51, F55, F91, LF2.

800#								
SIZES	F/F	ØP	ØA	B	C	H-OPEN	H-CLOSE	ØWH
15 mm	73	9.5	21.8	9.5	14.0	159	143	86
20 mm	80	12.7	27.2	12.5	16.0	162	146	86
25 mm	100	17.5	33.9	12.5	20.0	191	171	116
32 mm	145	23.8	42.7	12.5	20.0	228	199	150
40 mm	145	28.6	48.8	12.5	24.0	228	199	150
50 mm	160	36.5	61.2	16.0	26.0	265	236	150

HYDRO TEST PRESSURE (15 Sec.)	
	800#
SHELL/BODY	211 kg / cm <sup>2</sup>
SEAT	153 kg / cm <sup>2</sup>
BACK SEAT	153 kg / cm <sup>2</sup>
PNEUMATIC TEST PRESSURE (15 Sec.)	
SEAT	7 kg / cm <sup>2</sup>

16	BACK SHEET	INTEGRAL	-
15	HAND WHEEL	SG IRON/MI	1
14	STEM NUT	ASTM A 194 GR. 2H/B8/B8M	1
13	YOKE SLEEVE	BS970: 1955 EN1A	1
12	STUD NUT	ASTM A 194 GR. 2H/B8/B8M	2
11	GLAND FLANGE	ASTM A105/F304/F316/F11/F22	1
10	STUD	ASTM A 193 GR. B7/B8/B8M	2
9	GLAND BUSH	ASTM A 276 TYPE SS-410/304/304L/316/316L	1
8	GLAND PACKING	FLEXIBLE GRAPHITE RINGS	5
7	HEX BOLT	ASTM A 193 GR. B7/B8/B8M	4
6	BONNET	ASTM A105/F304/F304L/F316/F316L/F5/F9/F11/F22/F51/F55/F91/LF2	1
5	GASKET	SS-304 SPRIAL WOUNDED GRAPHITE	1
4	STEM	ASTM A 182 GR. F6a/F304/F304L/F316/F316L	1
3	PLUG	ASTM A 217 GR. CA-15/CF8/CF3/CF8M/CF3M	1
2	SEAT RING	ASTM A 182 GR. F6a/F304/F304L/F316/F316L	1
1	BODY	ASTM A105/F304/F304L/F316/F316L/F5/F9/F11/F22/F51/F55/F91/LF2	1
NO.	DESCRIPTION	MATERIALS	Qty.